

ADA NOTES

- 1 **ACCESSIBLE ROUTE - EXTERIOR:**
PER 104.2 OF NCBC, EXTERIOR ACCESSIBLE PATH OF TRAVEL SHALL BE 48" MIN. WIDE. THE MEASUREMENT SHALL BE BETWEEN HANDRAILS. IF ACCESSIBLE ROUTE HAS LESS THAN 5' CLEAR WIDTH, THEN PASSING SPACES AT LEAST 5'X5' SHALL BE LOCATED EVERY 200' OR LESS (INTERSECTING SIDEWALKS MEET THIS REQUIREMENT). LONGITUDINAL (RUNNING) SLOPE MAY NOT EXCEED 5% UNLESS RAMP IS INSTALLED (RAMPS MAY NOT EXCEED 0.33%). CROSS SLOPE MAY NOT EXCEED 2%. GAPS IN ROUTE MAY NOT EXCEED 1/2" IN WIDTH.
- 2 **FINISHED SURFACE HEIGHT DIFFERENCE REQUIREMENTS:**
A. 0 TO 1/4" : NO REQUIREMENTS
B. 1/4" TO 1/2" : BEVEL WITH 1:2 SLOPE
C. LARGER THAN 1/2" : CONFORM TO REQUIREMENTS FOR RAMP
- 3 **RAMPS:**
• MAX RAMP SLOPE 0.33% (1:30)
• RAMPS STEEPER THAN 0.33% ARE NOT ACCEPTABLE.
• MAX RISE FOR ANY RAMP RUN IS 30" (AT 0.33% SLOPE, MAXIMUM RUN OF RAMP IS 30').
• MAX CROSS SLOPE OF RAMP 2% (1:50)
A. LANDINGS:
• RAMPS SHALL HAVE LEVEL LANDINGS AT BOTTOM AND TOP OF EACH RAMP.
• LANDING SHALL BE AT LEAST AS WIDE AS RAMP LEADING TO IT.
• LANDING LENGTH SHALL BE MINIMUM 5' CLEAR.
• IF RAMPS CHANGE DIRECTION AT LANDING, MINIMUM LANDING SIZE SHALL BE 5'X5'.
• ALL LANDINGS ARE TO BE NO MORE THAN 2% SLOPE IN ANY DIRECTION.
B. HANDRAILS:
• HANDRAILS REQUIRED ON BOTH SIDES (MIN. 36" CLEAR BETWEEN HANDRAILS) WHEN RAMP RISE IS GREATER THAN 6".
• PROVIDE MINIMUM 12" LONG HANDRAIL EXTENSIONS AT TOP AND BOTTOM LANDINGS.
• PROVIDE MINIMUM 2" HIGH EDGE PROTECTION OR RAIL WITH LESS THAN 4" CLEAR TO RAMP IF RAMP HAS DROP-OFFS.
• ROUTES BETWEEN BUILDINGS WITH ONLY DWELLING UNITS DO NOT HAVE TO HAVE HANDRAILS.
• STAIRS NOT ALLOWED AS PART OF ACCESSIBLE ROUTE BUT IF ADJACENT TO ROUTE OR PART OF TENANT SPACE MUST MEET REQUIREMENTS FOR STAIR RAILS.
- 4 **CURB RAMPS:**
• MAX SLOPE OF CURB RAMP 0.33%.
• MAX SLOPE OF SIDE FLARES 10%.
• MAX SLOPE OF ADJOINING GUTTERS, ROAD SURFACE, OR ACCESSIBLE ROUTE 5%.
• MIN WIDTH 36" (NOT INCLUDING SIDE FLARES).
• DETECTABLE WARNING IS REQUIRED ON CURB RAMPS IN PUBLIC RIGHTS OF WAY, AND SHALL BE 24" MINIMUM IN THE DIRECTION OF TRAVEL AND EXTEND THE FULL WIDTH OF THE CURB RAMP OR FLUSH SURFACE. DETECTABLE WARNINGS SHALL BE LOCATED SO THE EDGE NEAREST THE CURB LINE IS 6" TO 8" FROM THE CURB LINE.
- 5 **PAVEMENT MARKINGS:**
AS REQUIRED BY LOCAL JURISDICTIONAL AUTHORITY (RECOMMENDED CROSSWALK MARKING TO DESIGNATE ACCESSIBLE PEDESTRIAN ROUTE)
- 6 **PARKING SPACES:**
• MINIMUM 8' WIDE ACCESSIBLE PARKING SPACE
• MINIMUM 5' WIDE ACCESS AISLE AT STANDARD SPACES
• MINIMUM 8' WIDE ACCESS AISLE AT VAN ACCESSIBLE SPACES
• MAXIMUM 2% (1:50) SLOPE IN ANY DIRECTION
- 7 **ACCESSIBLE PARKING SUMMARY:**
PROPOSED ACCESSIBLE PARKING INCLUDES FIVE (5) 9' WIDE ACCESSIBLE PARKING STALLS AND TWO (2) 9' WIDE ACCESSIBLE AISLES.
- 8 **SIGNAGE:**
ACCESSIBLE PARKING SPACES SHALL BE DESIGNATED AS RESERVED BY A SIGN SHOWING THE SYMBOL OF ACCESSIBILITY. VAN ACCESSIBLE SPACES SHALL HAVE AN ADDITIONAL SIGN "VAN-ACCESSIBLE" MOUNTED BELOW THE SYMBOL. SUCH SIGNS SHALL BE LOCATED SO THEY CANNOT BE OBSCURED BY A VEHICLE PARKED IN THE SPACE (60" ABOVE GRADE UNLESS OTHER HEIGHT REQUIRED BY LOCAL JURISDICTION).
- 9 **ACCESSIBLE ROUTES AND AMENITIES:**
MUST COMPLY WITH ADA, THE FAIR HOUSING ACT AND ICC A117.1-2009.
- 10 **EXISTING ACCESSIBLE ROUTES AND AMENITIES:**
THE PUBLIC RIGHT-OF-WAY MUST REMAIN ADA COMPLIANT DURING CONSTRUCTION OR AN ALTERNATIVE ROUTE MUST BE PROVIDED.

OWNER NAME:
SCOTLAND COUNTY ECONOMIC
DEVELOPMENT CORP
PARCEL NUMBER:
02-0305-01-00101

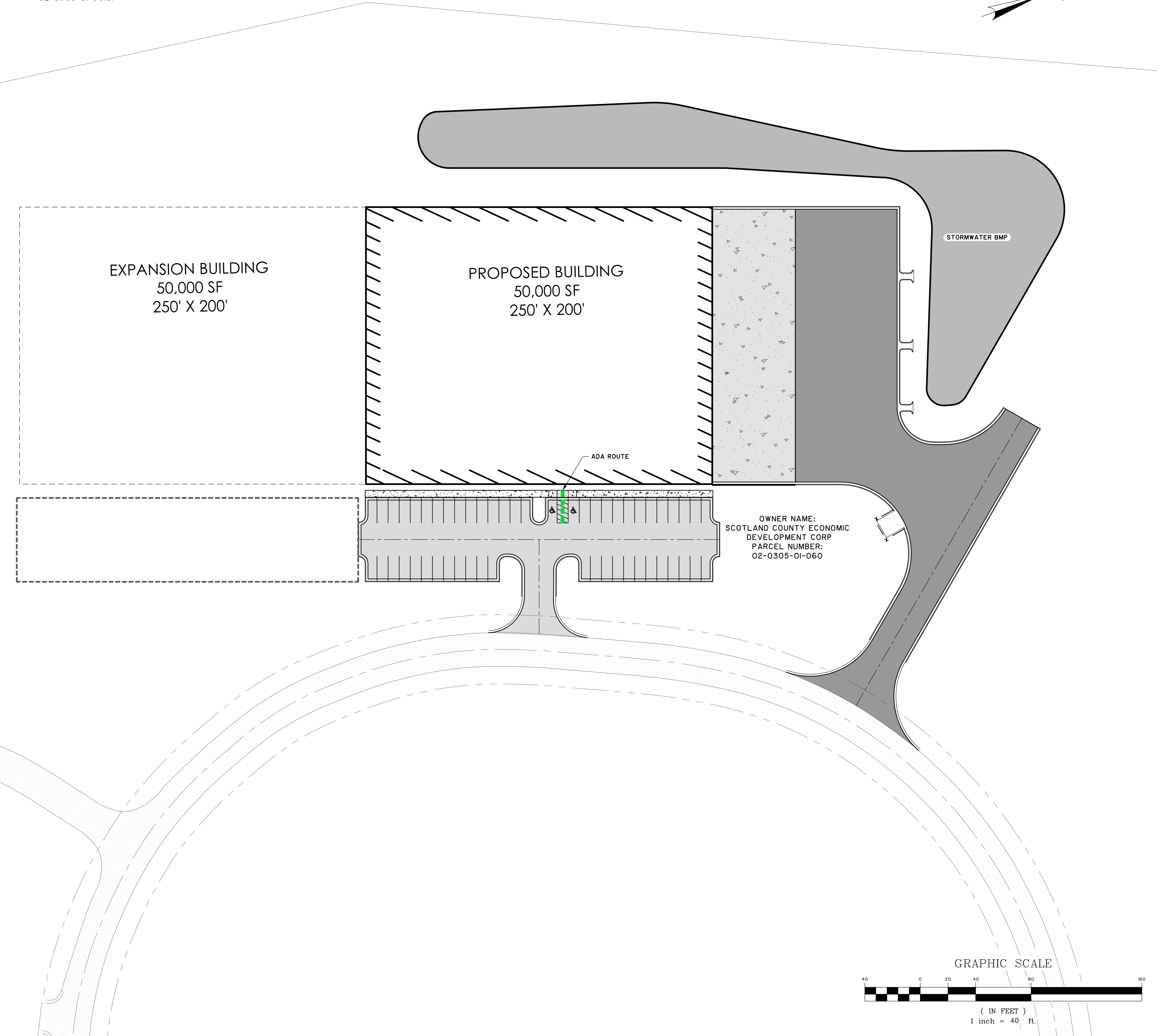

OWNER NAME:
SCOTLAND COUNTY ECONOMIC
DEVELOPMENT CORP
PARCEL NUMBER:
02-0305-01-060

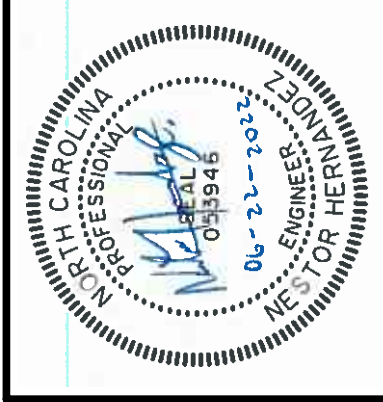
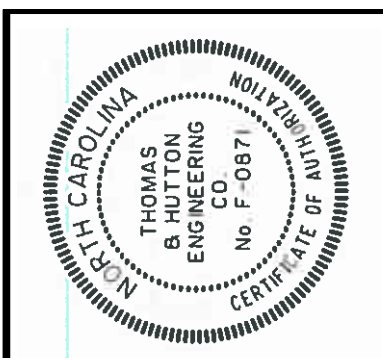
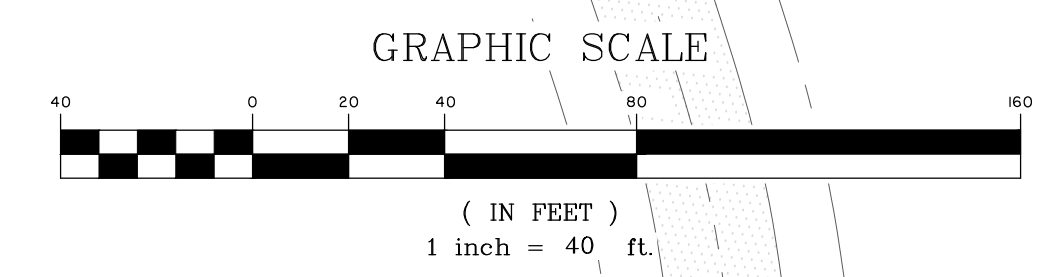

NO.	REVISIONS	BY	DATE

THOMAS & HUTTON
1020 Euclid Avenue
Charlotte, NC 28202 • 980.201.5505
www.thomasandhutton.com

SCOTLAND COUNTY ECONOMIC DEVELOPMENT CORPORATION
HECK NORTON ROAD, LAURINBURG, NC 29352
SCOTLAND COUNTY INCUBATOR PARK
ADA ROUTE PLAN

JOB NO:	J- 28853.0000
DATE:	6/21/22
DRAWN:	NH
DESIGNED:	NH
REVIEWED:	WBS
APPROVED:	WBS
SCALE:	1" = 40'

C1.1

PERMIT SET - FOR REVIEW PURPOSES ONLY